

So much more awesome DIY at
www.RealityDaydream.com

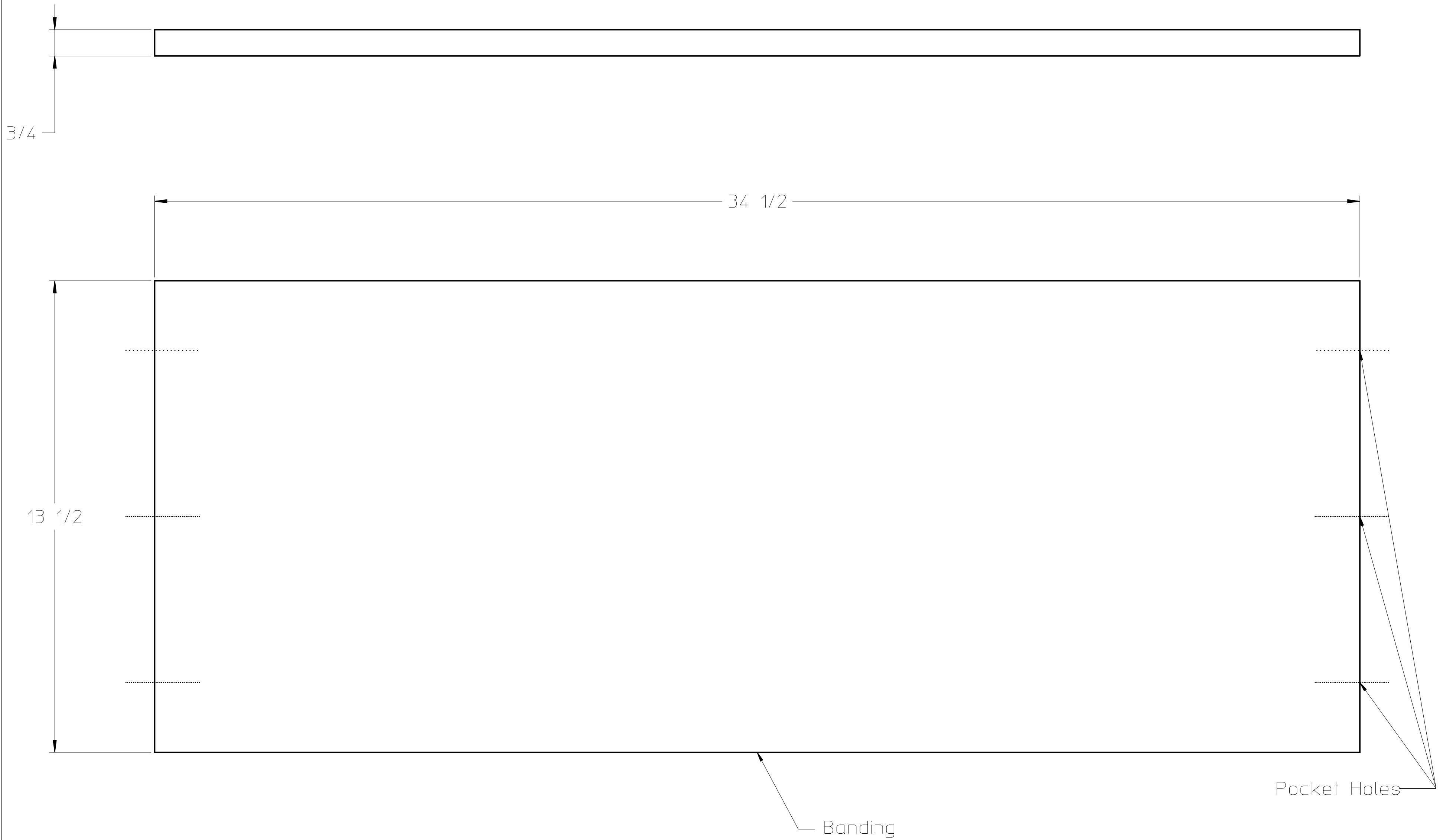

Carcass Top/Bottom



So much more awesome DIY at
www.RealityDaydream.com

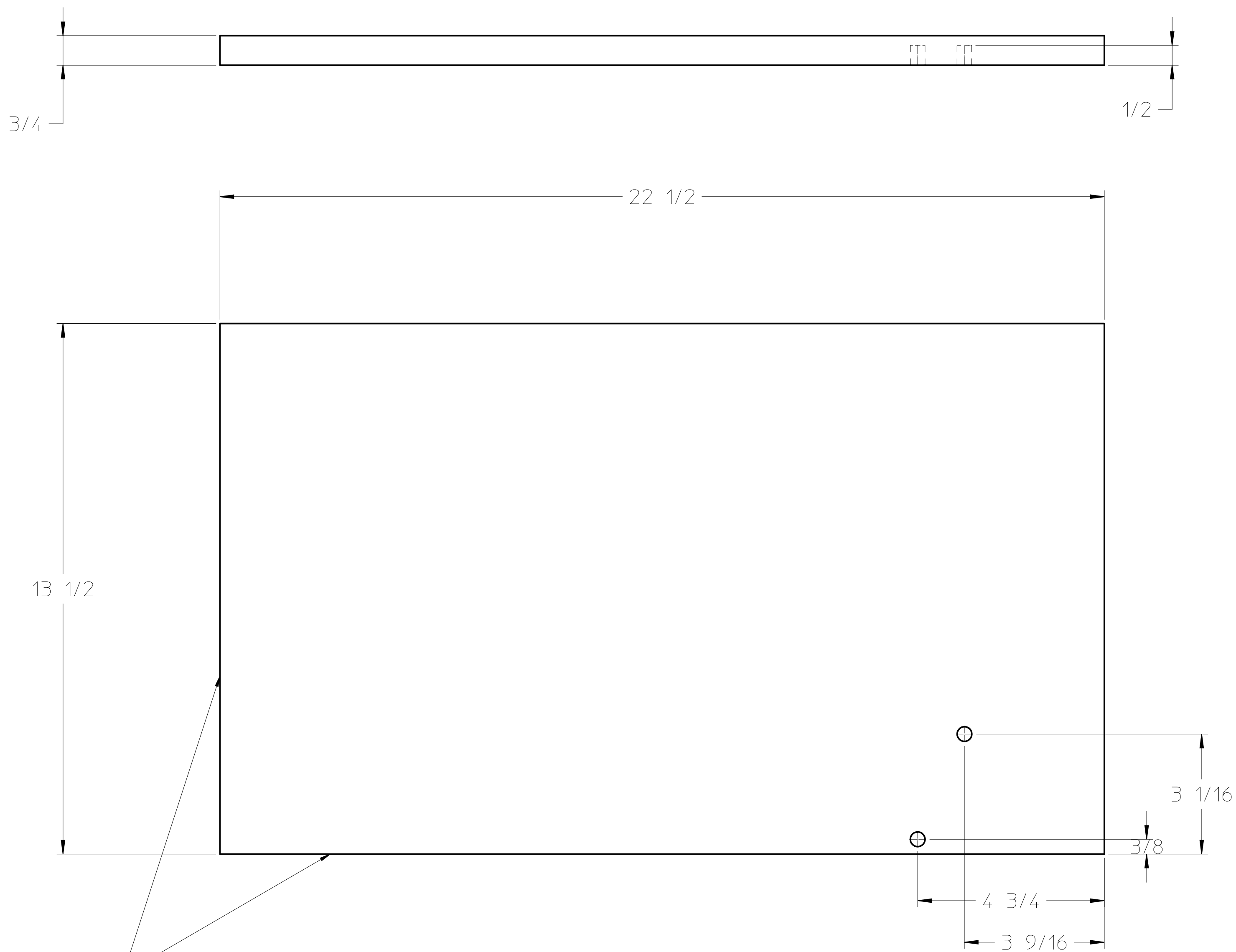

Side (Qty 2)



So much more awesome DIY at
www.RealityDaydream.com

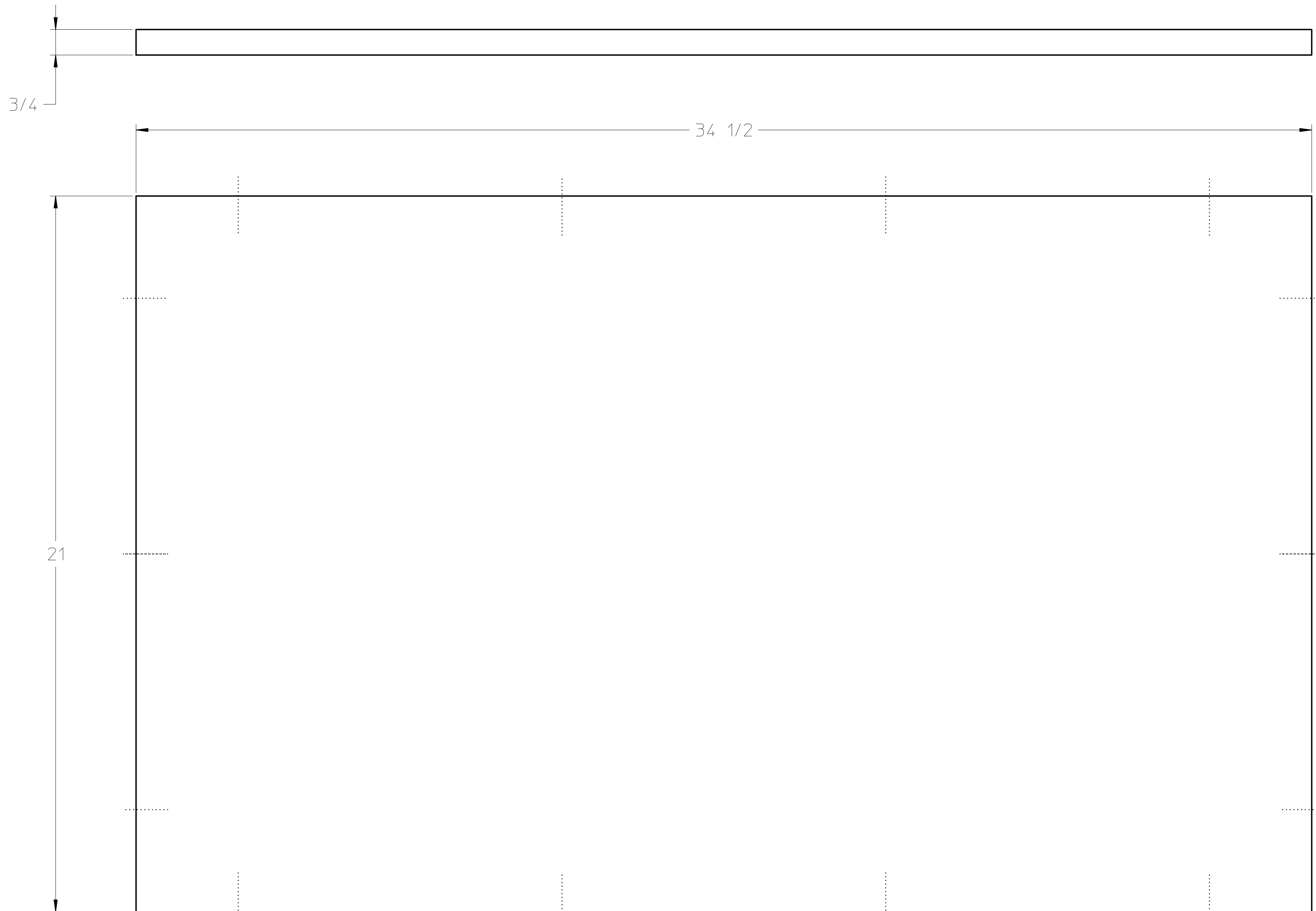

Pocket holes

Back, Carcaass



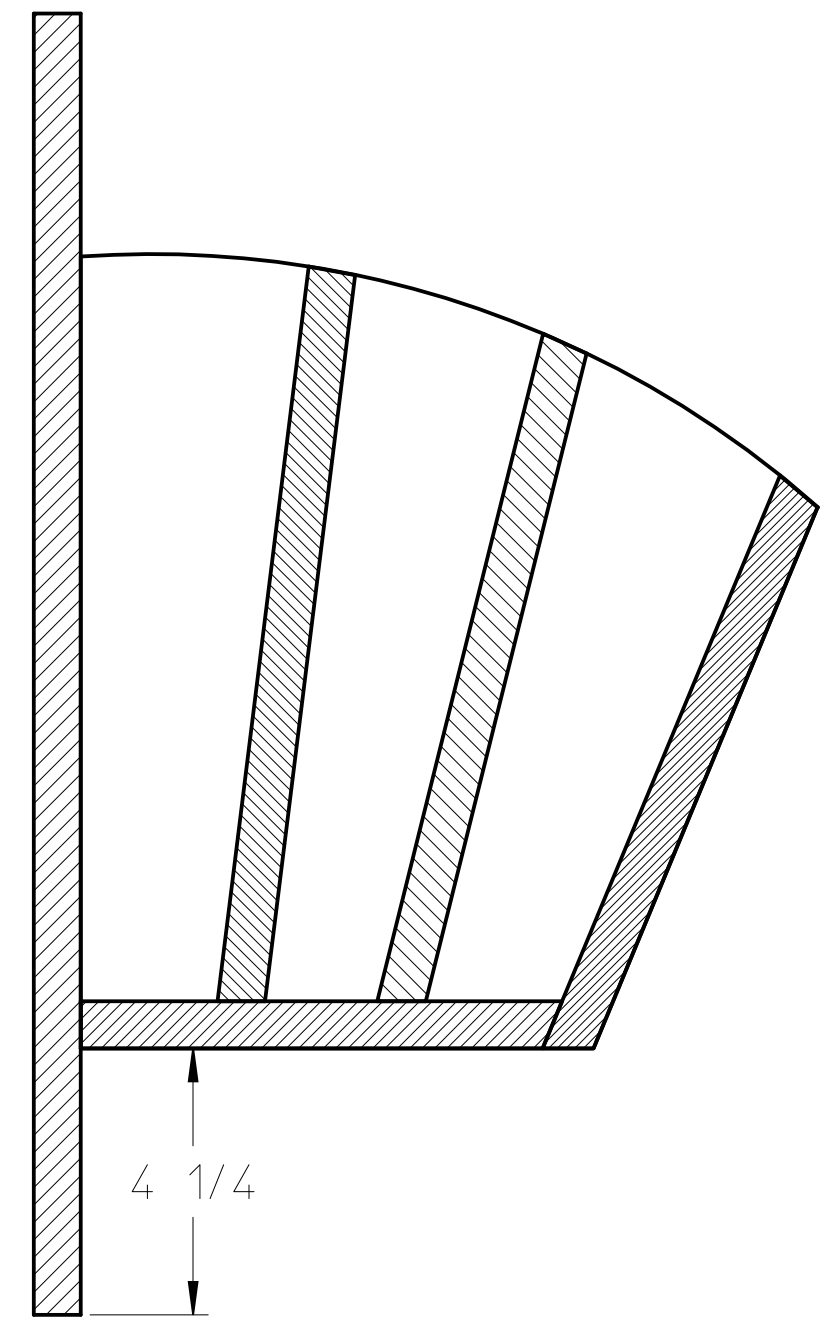
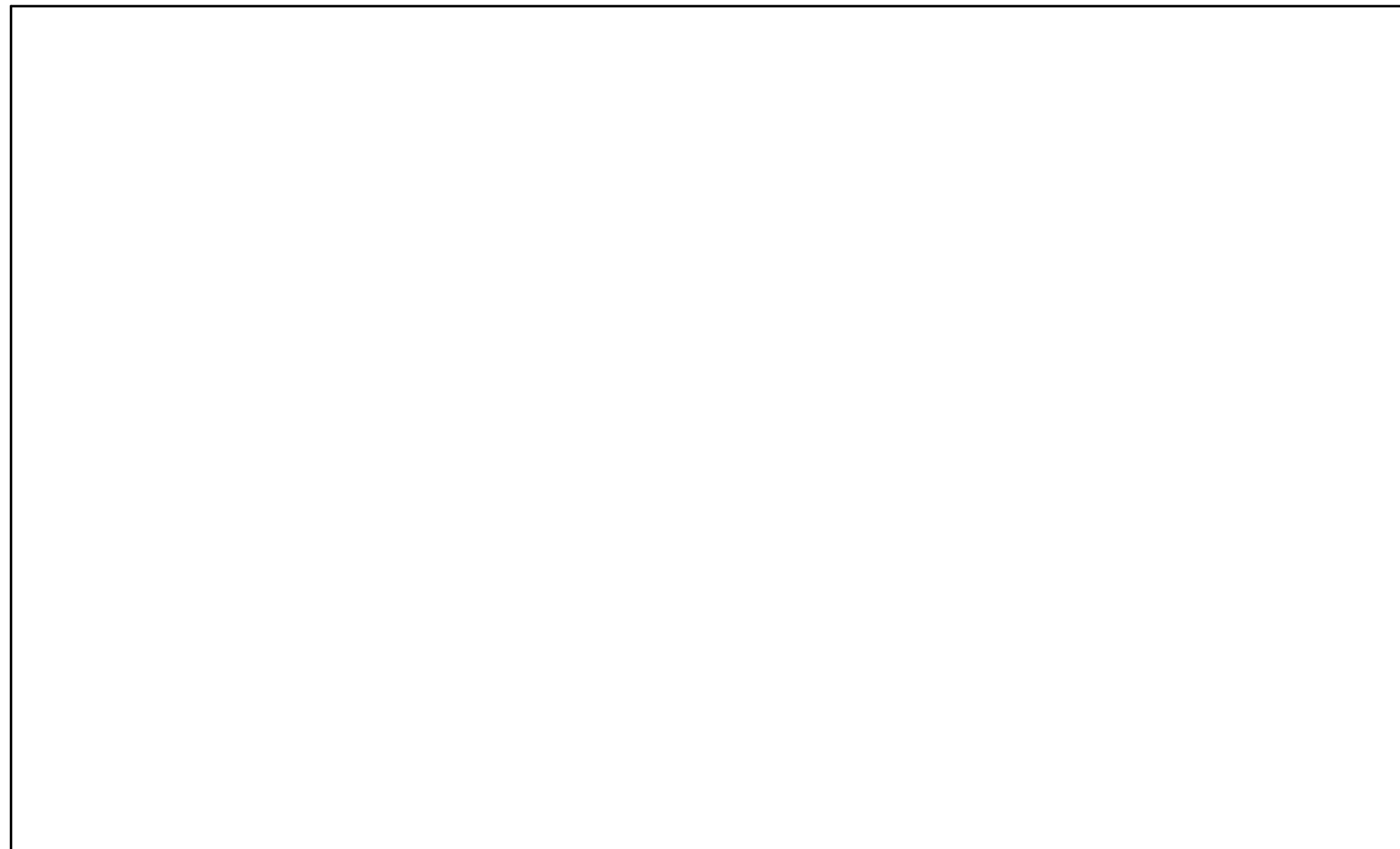
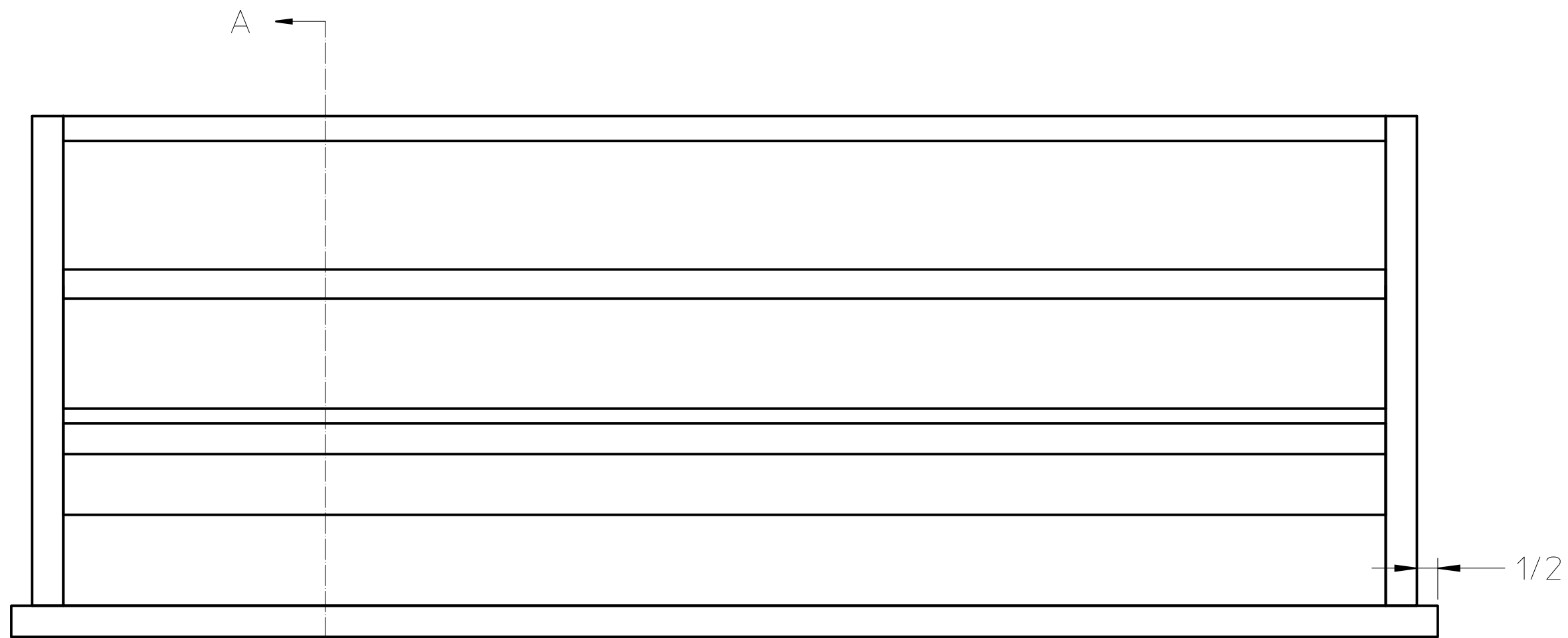

SECTION A-A
SCALE 1:3



So much more awesome DIY at
www.RealityDaydream.com

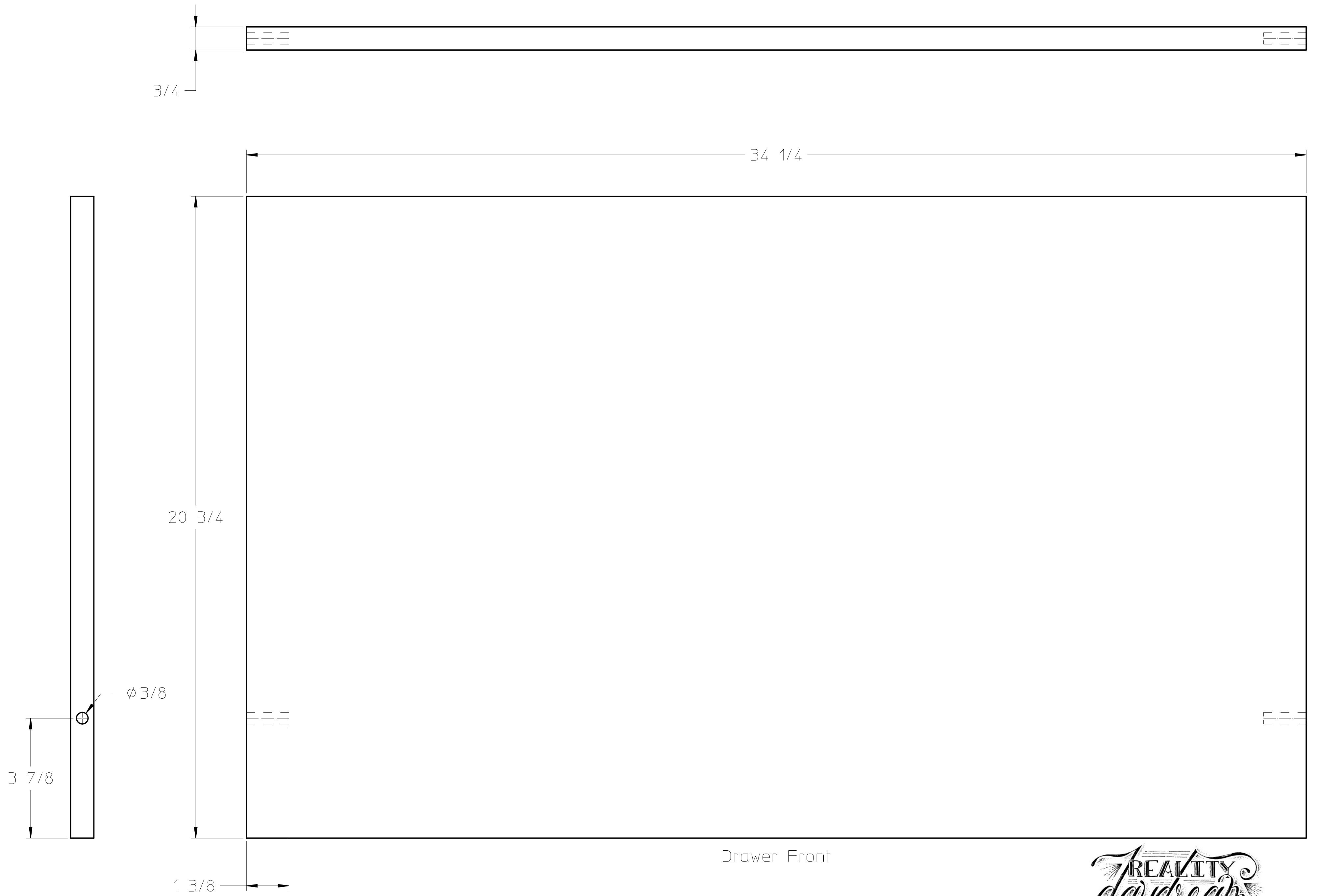

Drawer Front

Note:
Edge Band all edges



So much more awesome DIY at
www.RealityDaydream.com

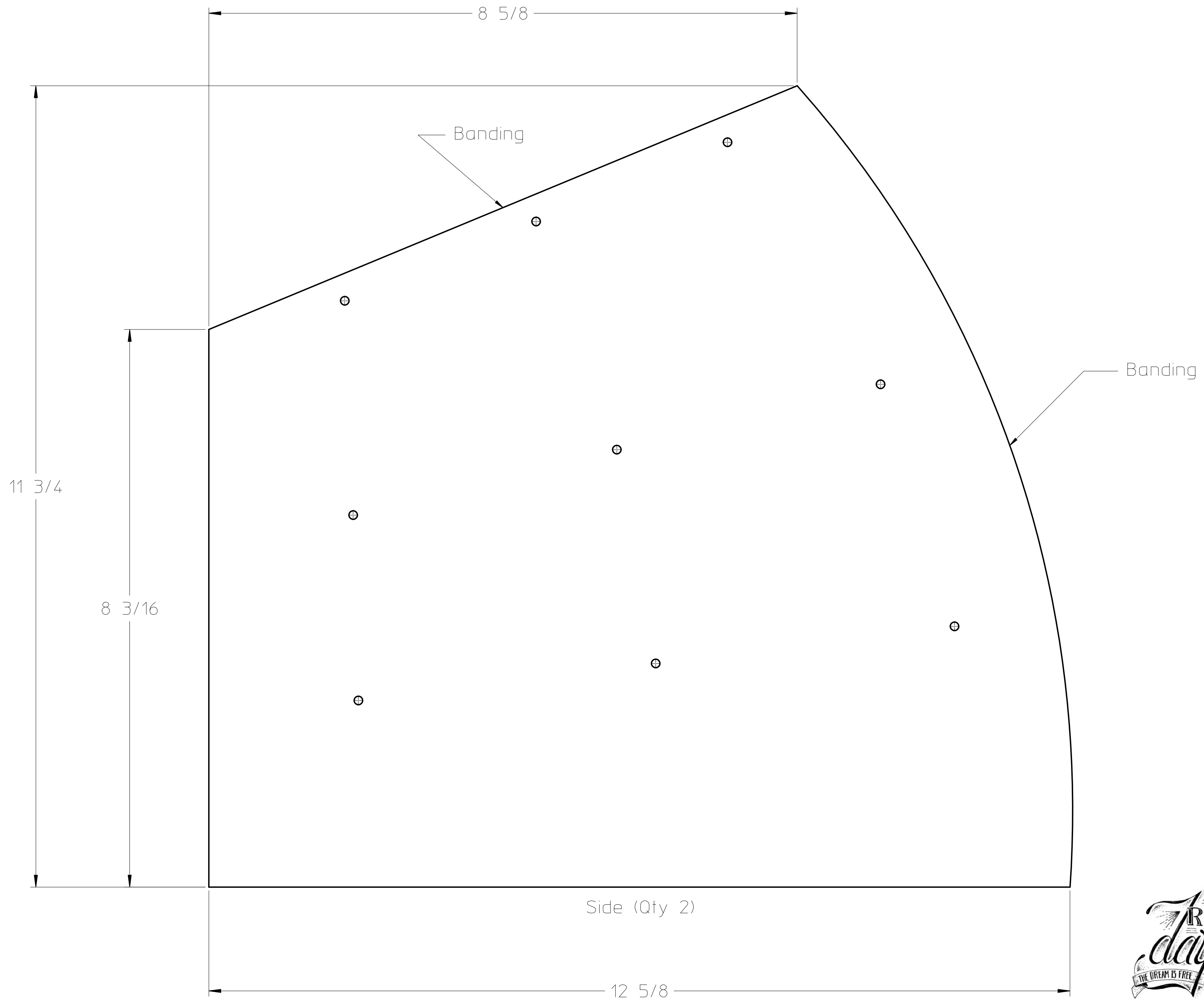

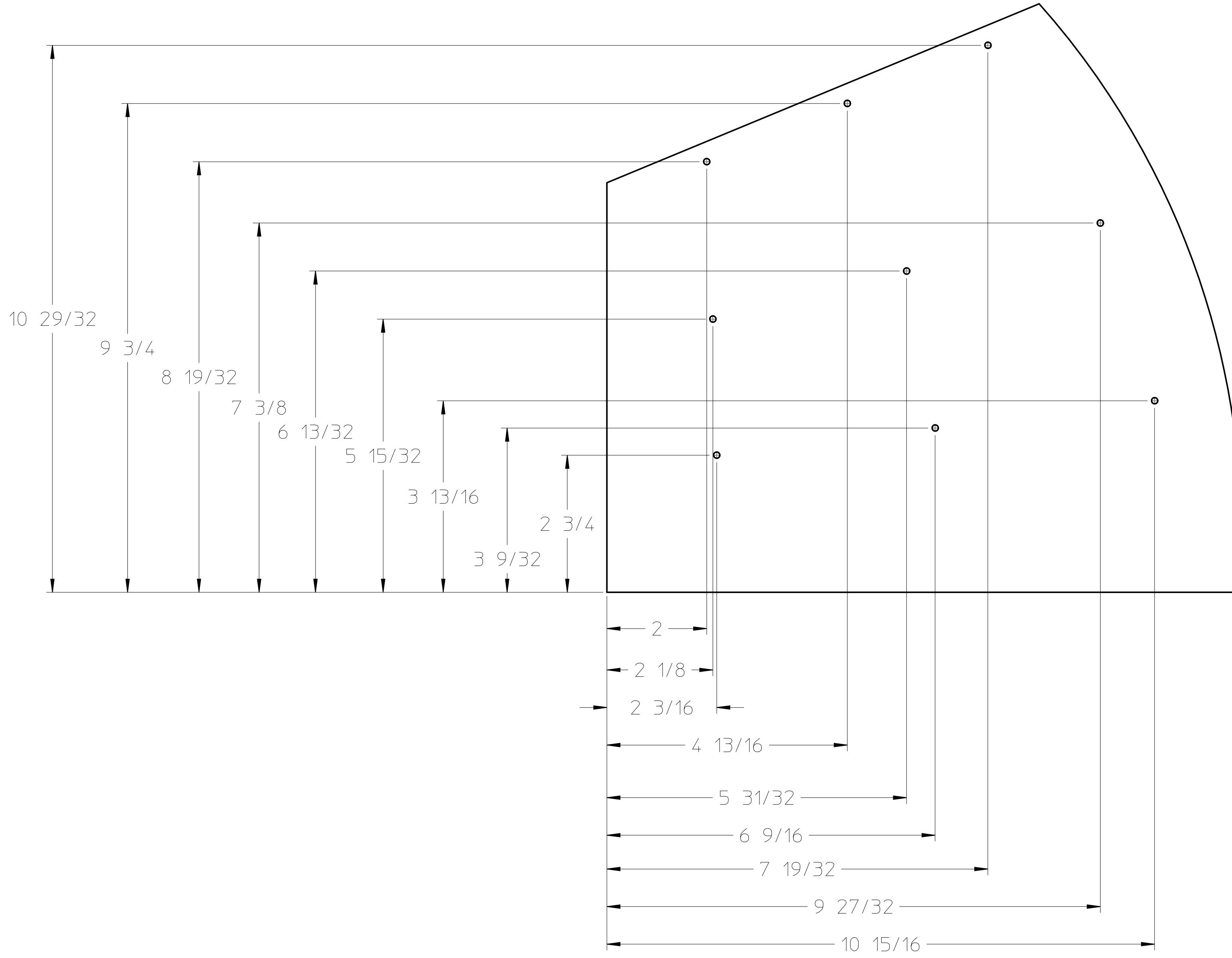

So much more awesome DIY at
www.RealityDaydream.com

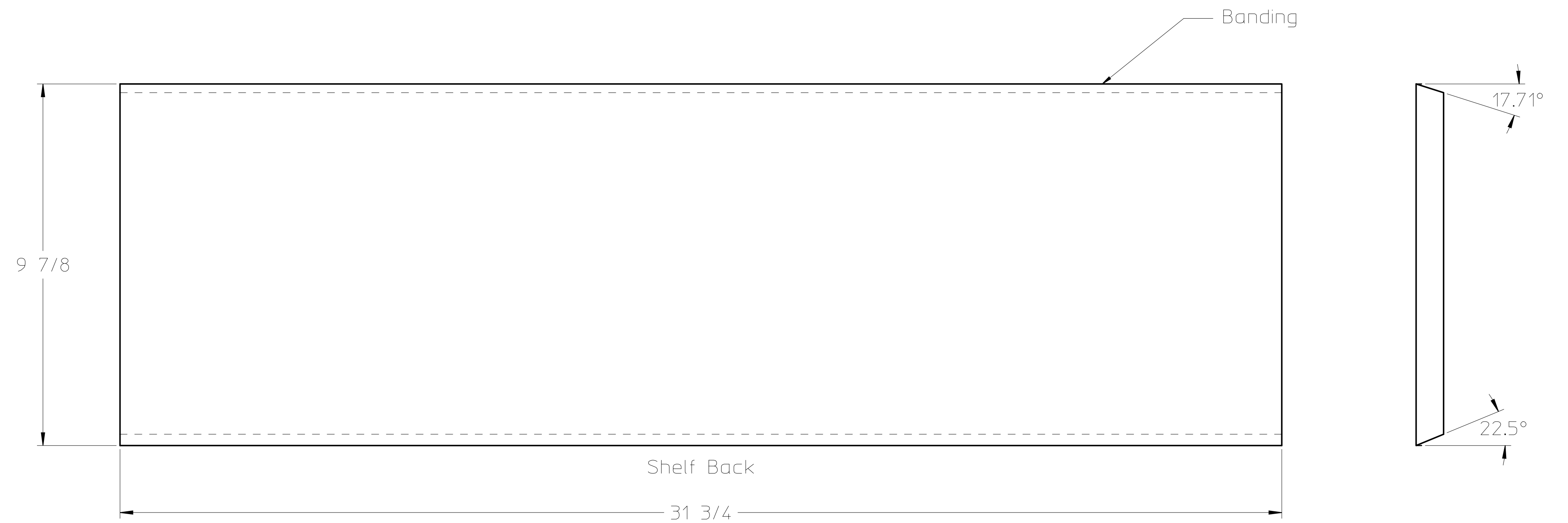
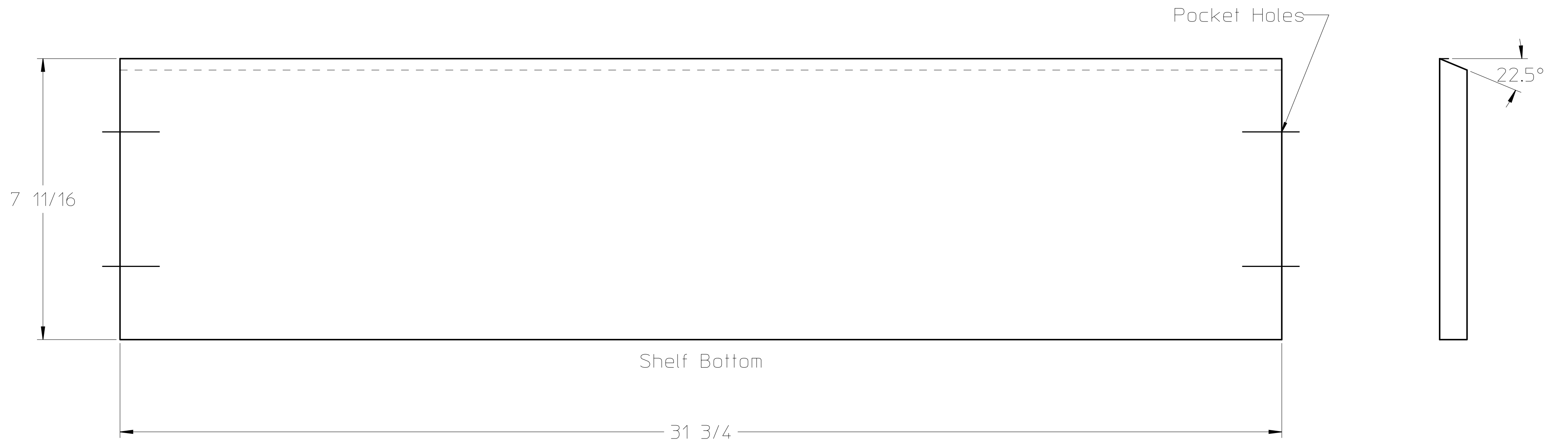

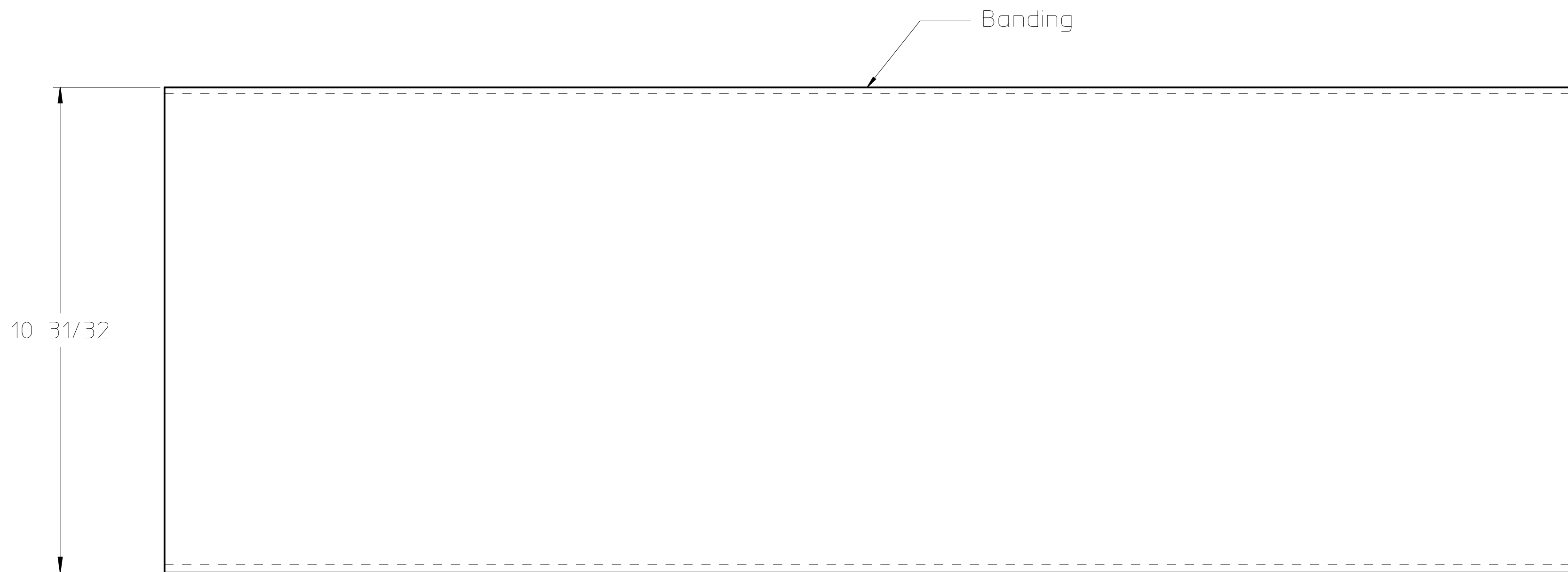

10.42°

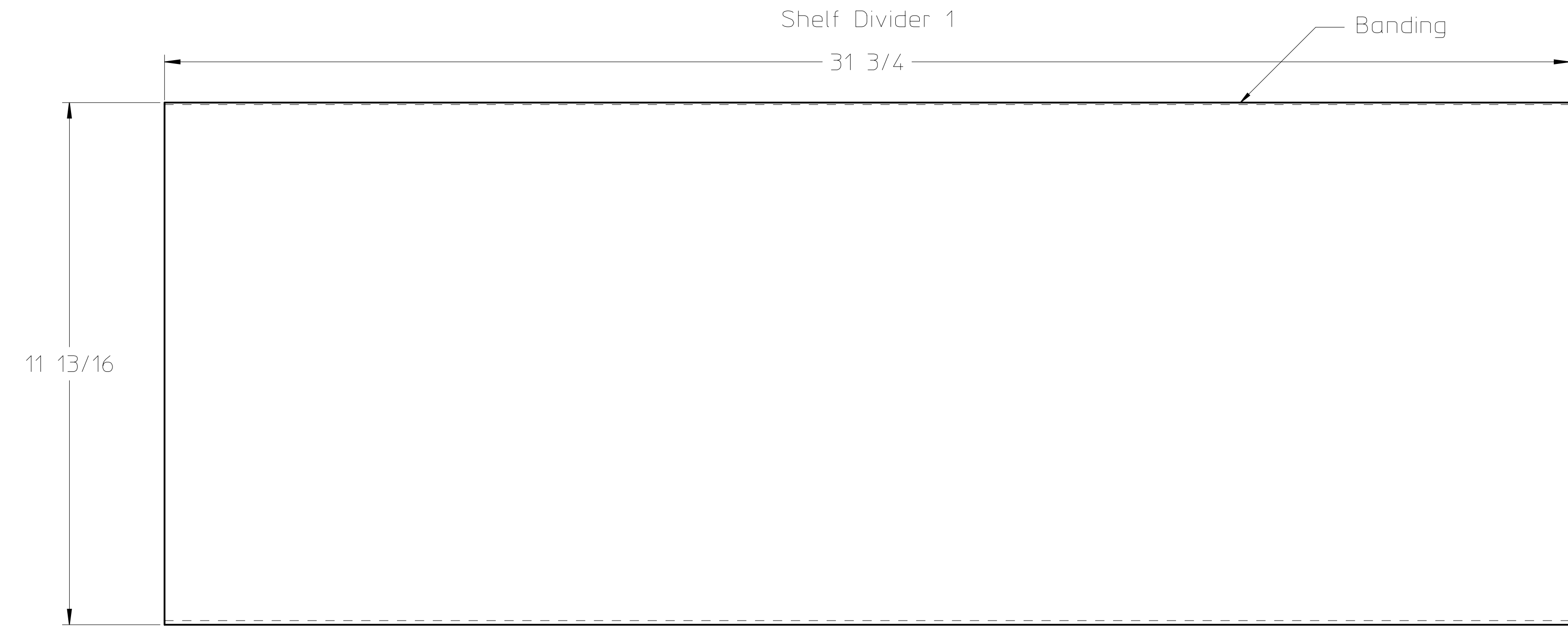

13.94°

3.3°

7.09°



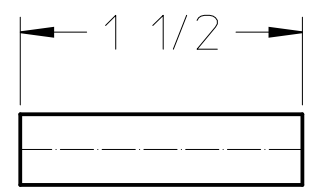

Stop Pin

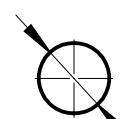

$\phi 3/8$

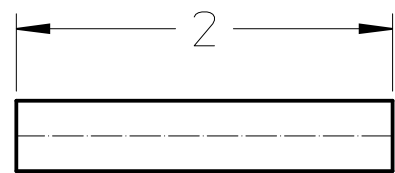

Hinge Pin

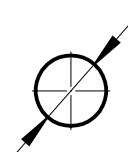

$\phi 3/8$



TOP7

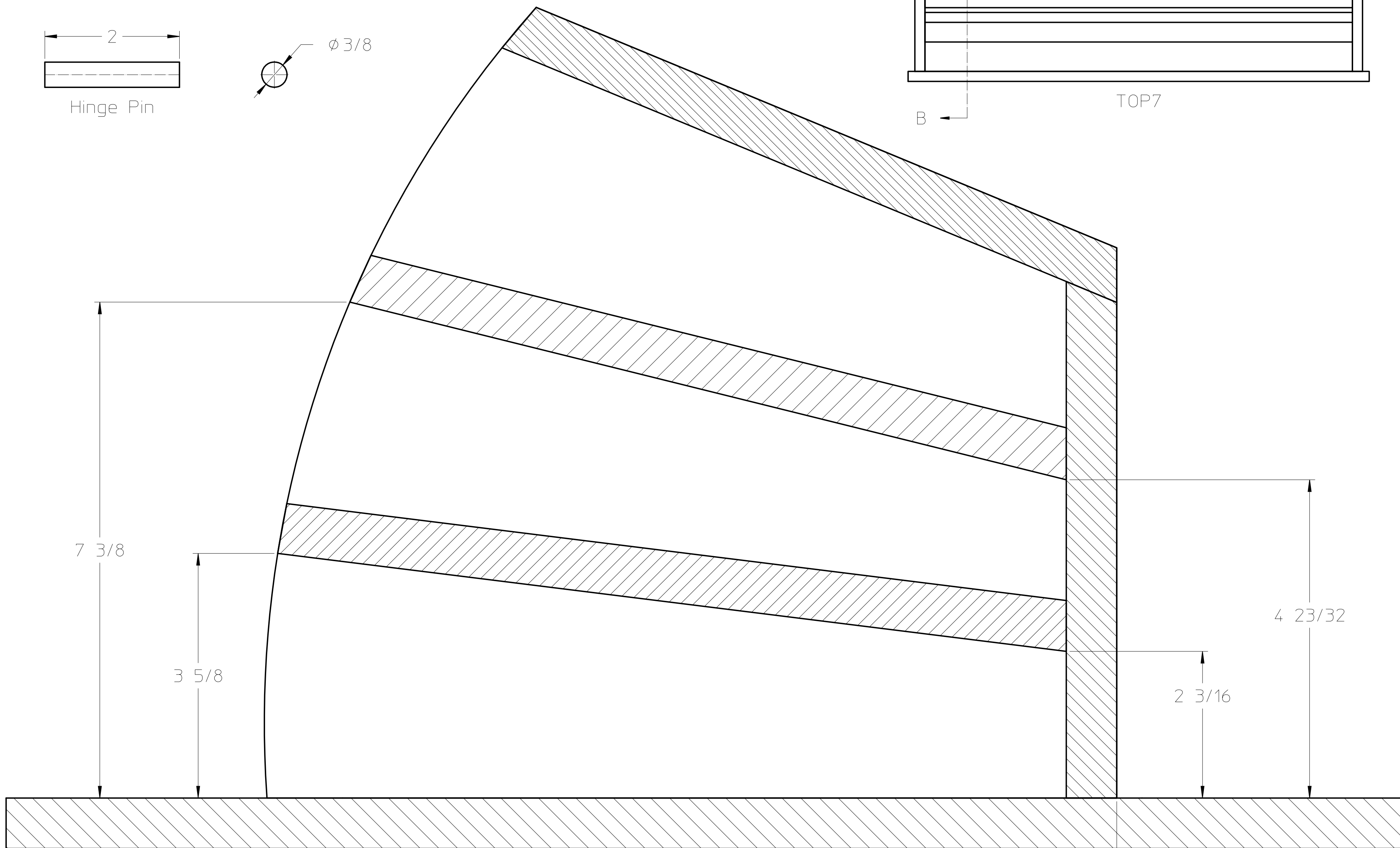

$7 \frac{3}{8}$

$3 \frac{5}{8}$

$4 \frac{23}{32}$

$2 \frac{3}{16}$

Shoe Shelf
Section B-B

$4 \frac{1}{4}$